

DCMS ASSEMBLY

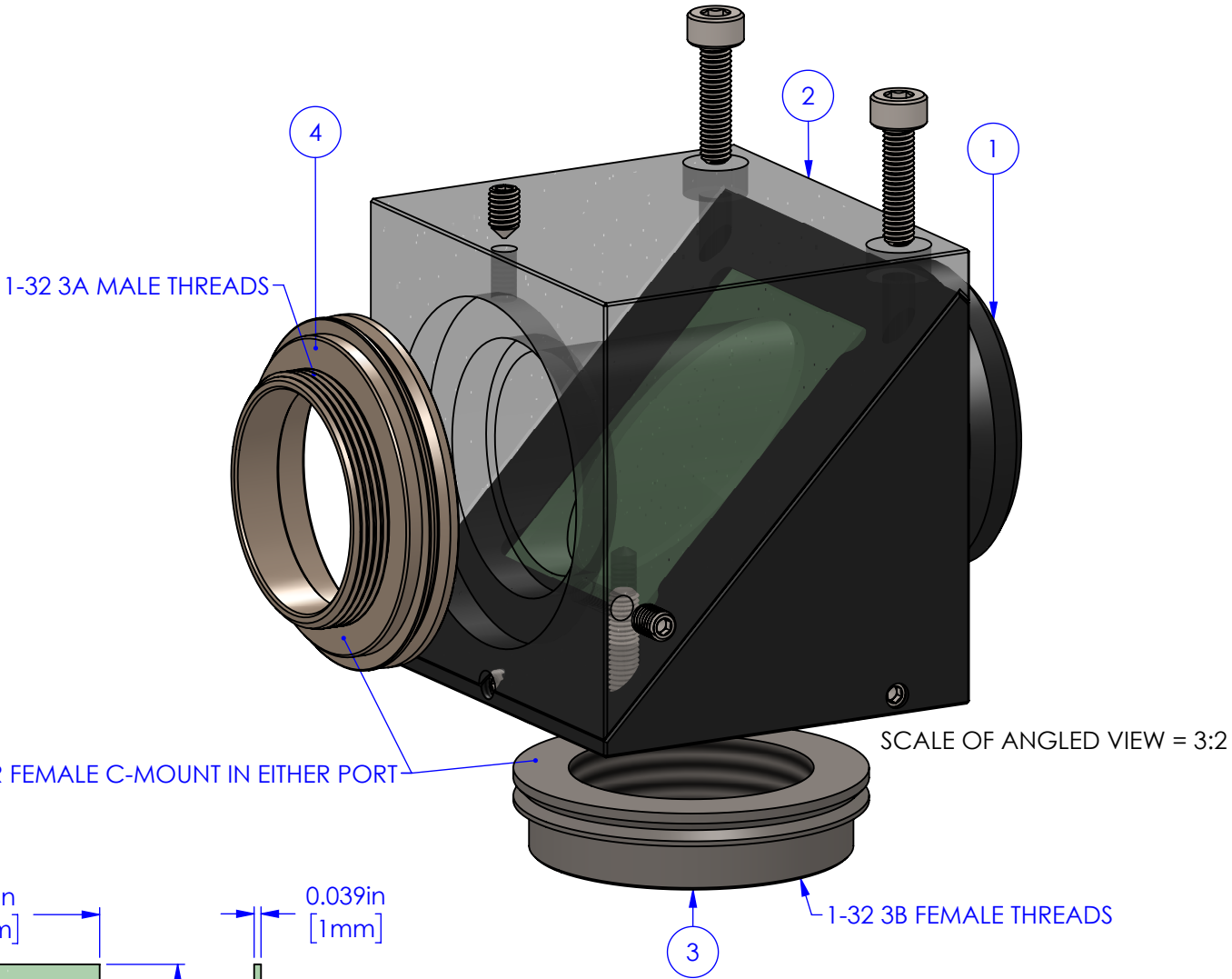

SECTION G-G

C-202-F IS AN **OPTION** TO TAKE THE PLACE OF THE C-202 DCMS CUBE BOTTOM

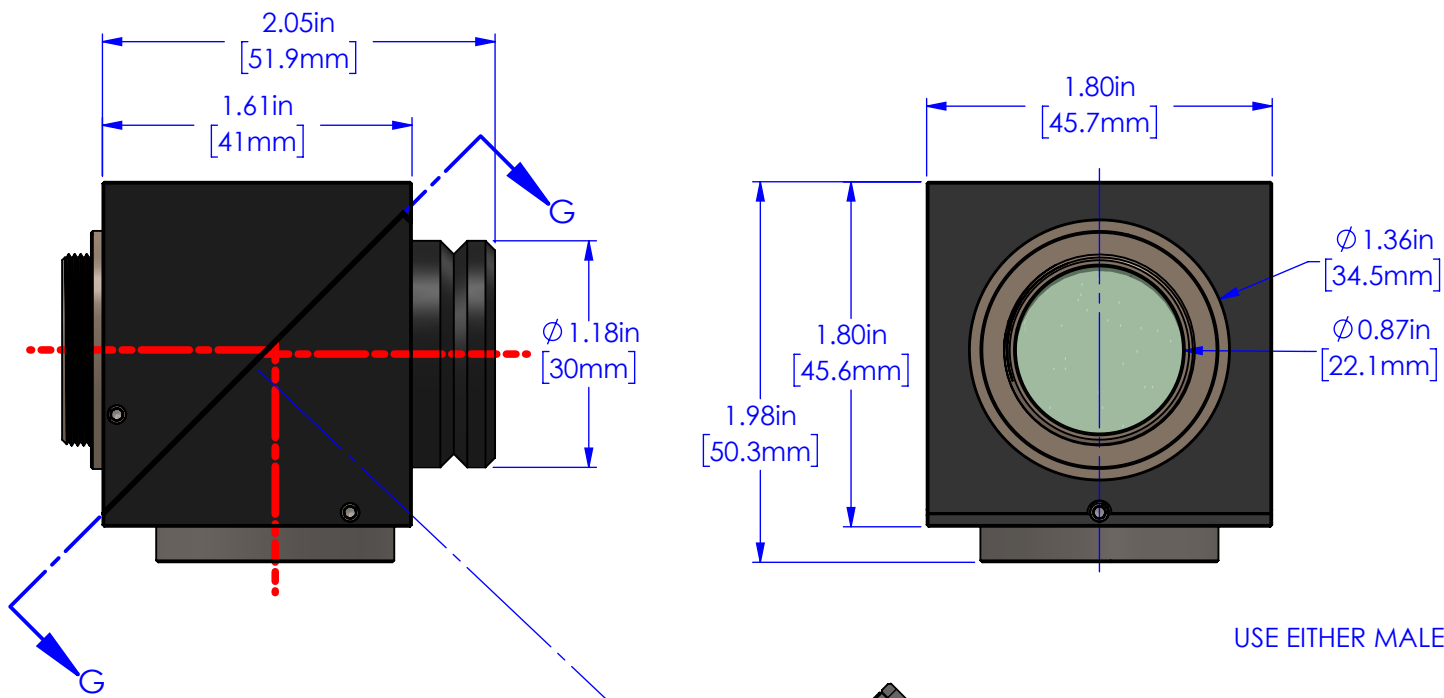
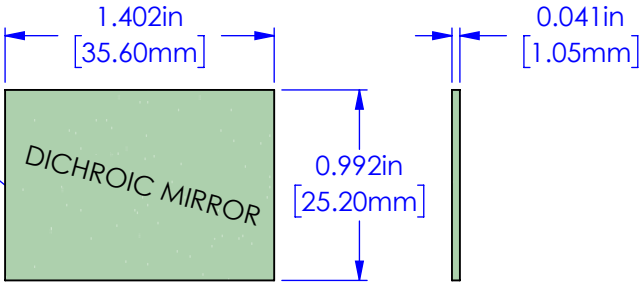
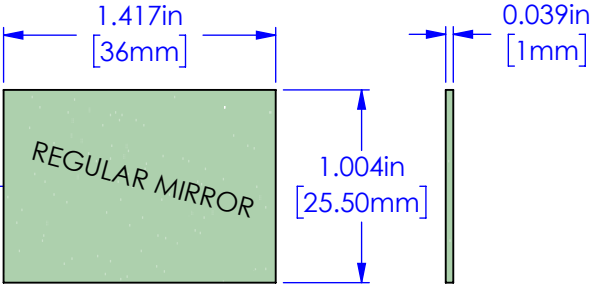
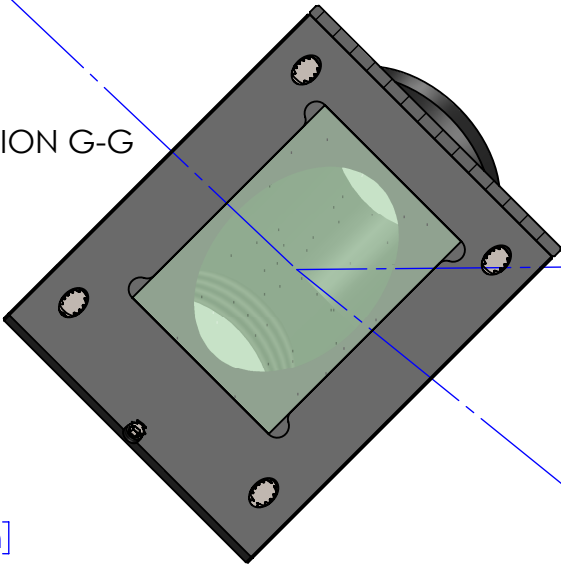
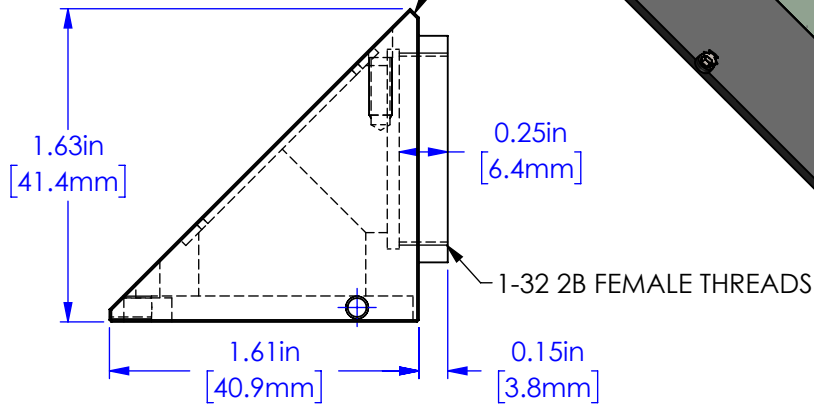

ITEM NO.	PART NUMBER	QTY.
1	C-202 DCMS CUBE BOTTOM	1
2	C-203 DCMS CUBE TOP	1
3	FW-3009 FEMALE C-MOUNT	1
4	FW-3010 MALE C-MOUNT	1



PROPRIETARY AND CONFIDENTIAL
THE INFORMATION CONTAINED IN THIS DRAWING IS THE SOLE PROPERTY OF APPLIED SCIENTIFIC INSTRUMENTATION. ANY REPRODUCTION IN PART OR AS A WHOLE WITHOUT THE WRITTEN PERMISSION OF APPLIED SCIENTIFIC INSTRUMENTATION IS PROHIBITED.

APPLIED SCIENTIFIC INSTRUMENTATION
29391 W ENID RD
EUGENE, OR 97402-9533
PHONE: (541)461-8181
FAX: (541)461-4018

DRAWN BY/DATE
M.ANTHONY 8-1-2012

CHECKED BY/DATE
V.MARSO

UNLESS OTHERWISE SPECIFIED
.XX ± .01
.XXX ± .005
.XXXX ± .0002
FRACTIONS ± 1/32
ANGLES ± 1°

DESCRIPTION

SCALE
1:1

REV
0

DRAWING #

DCMS ASSEMBLY

DCMS ASSEMBLY.SLDDRW